

FINALIST



SUBMITTED BY:
AECOM

DESIGN TEAM:

Gregory Mare, Vice President, Healthcare Practice Leader, Americas; **Christine Hester Devens**, Associate Principal, Interior Project Designer; **James Thomson**, Vice President and Managing Principal; **Matthew Sanders**, Principal, Design Director; **Kristina Johnston**, Director, Interiors Operations; **Jim Lewison**, Associate Principal, Interior Design Director; **Shannon Bambery**, Medical Planner

THE CONCEPT:

Hello Care. Personalized healthcare: same day delivery.

In the rapidly approaching future, consumers will expect personalized healthcare when and where they need it. What if you could order your autonomous personalized healing environment online and have it delivered wherever you want – to your home, the woods, or your workplace? Your modular healthcare space, through telehealth and robotics, could support diagnostic and interventional procedures, sub-acute or transitional care and wellness when and where you choose.

Hello Care would offer consumers convenience and personalized care. Healthcare providers and insurers would value the improved outcomes and reduced costs resulting from increased access, fewer re-admissions or emergency department visits, and reduced clinic- and hospital-acquired infections.

As today's healthcare facility designers conceive future-ready building concepts, anticipation of innovative care solutions like Hello Care will be imperative. The potential impact on volumes, building program and infrastructure will be a game changer for healthcare organizations!

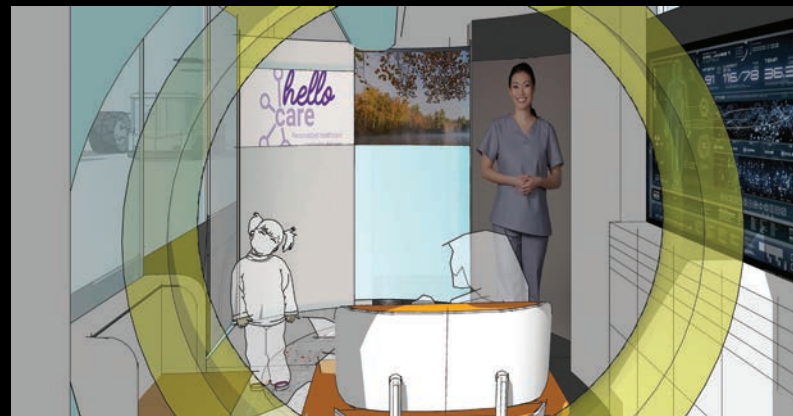

The interior space is comfortable and adaptable to different patient needs.

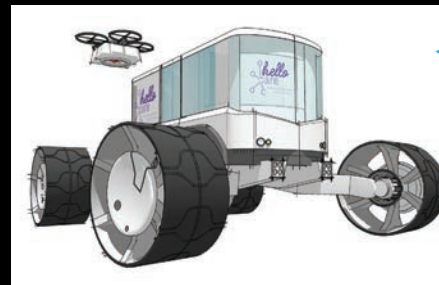

The Hello Care environment can provide care wherever the patient is located through different chassis.



Hello Care is a system of autonomous environments that bring care to you.

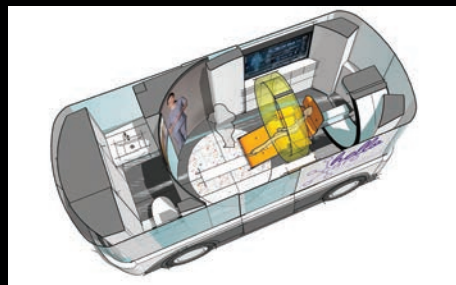

The interior has multiple configurations; shown is the standard patient care/exam space.

For each visit, a caregiver is virtually located next to the patient via a large interactive screen

